

This guide presents the terminology that we use at bigHead to describe the individual components within a bigHead, the configuration of the components, and details specific to certain components. Please note that the drawings and images are for illustration purposes only and do not imply actual dimensions or exact geometry.

bigHead: general configuration

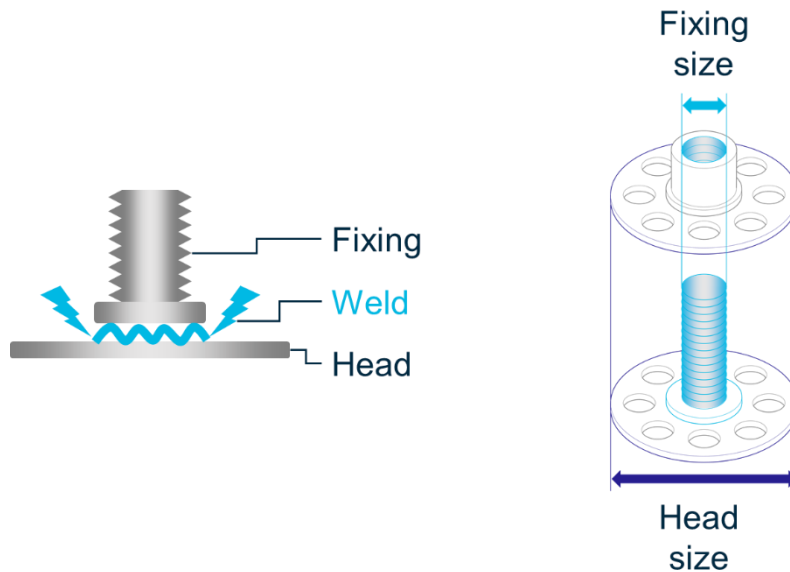

Head types and details

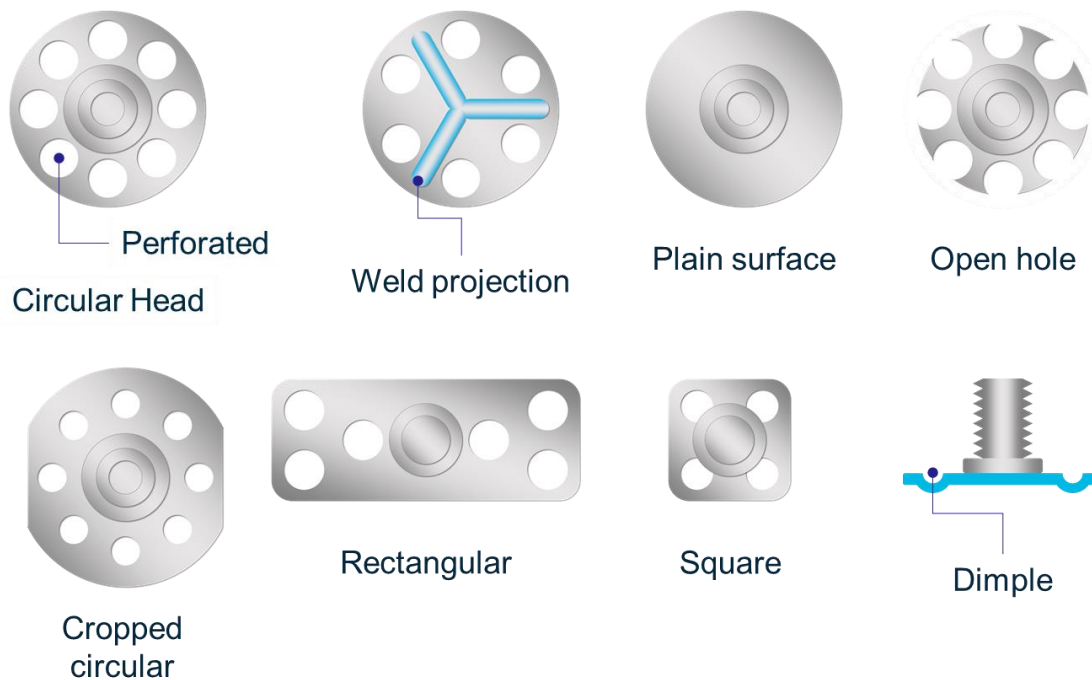

Fixing types

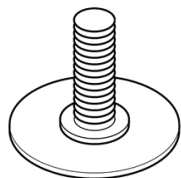

Threaded stud

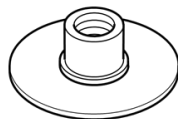

Threaded collar

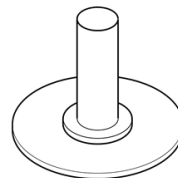

Plain pin

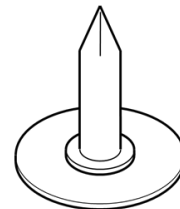

Nail

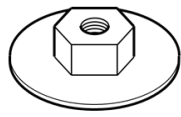

Hex*

*Hex: bigHead specific fixing design similar in shape to a "nut", but NOT conforming to standard dimensions/series

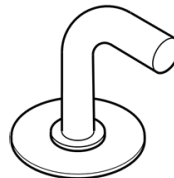

Hook

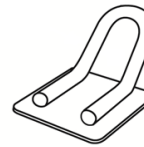

Loop



Cable tyrap

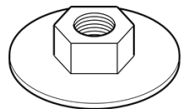

Threaded nut*

*Nut: threaded nut conforming to standard dimensions/series

Fixing details

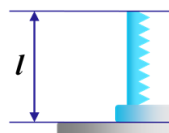
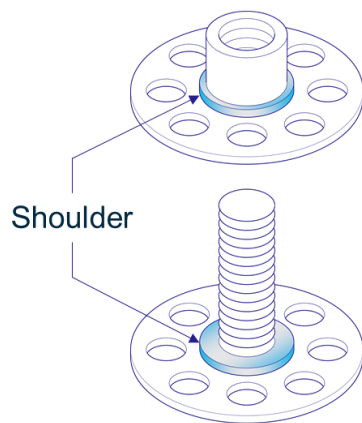

Collar length

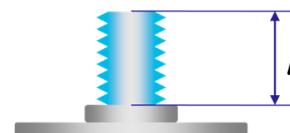

Stud length

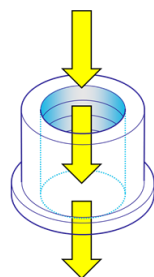

Open collar

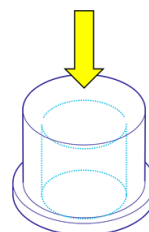

Closed collar

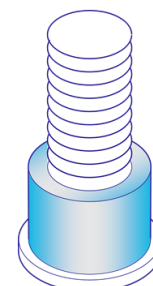

Stepped shoulder

bigHead configuration options

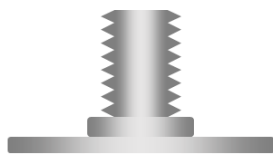

Threaded stud

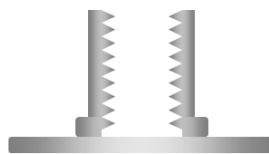

Threaded collar;
Blind

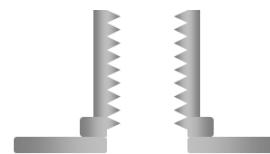

Threaded collar;
Sighted

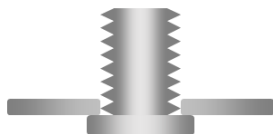

Reverse weld:
Stud

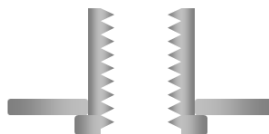

Reverse weld:
Open collar

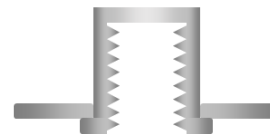

Reverse weld:
Closed collar

Materials

BZP	Bright Zinc Plate, typically used on Carbon steel products
Carbon steel	Fixings and Heads manufactured from carbon steel
PC 4.6	A steel Head or fixing with equivalent material properties to grade 4.6 carbon steel
PC 8.8	A steel Head or fixing with equivalent material properties to grade 8.8 carbon steel
316 Stainless	A stainless-steel Head or fixing with equivalent material properties to 316 stainless steel
Stainless	An unspecified grade or property class of stainless steel

Timing and concentricity

